

SCHEDA DATI PRODOTTO

Sika AnchorFix[®] S

UNIVERSAL ANCHORING ADHESIVE

DESCRIZIONE DI PRODOTTO

Styrenated polyester based 2-component anchoring adhesive.

IMPIEGHI

Sika AnchorFix[®] S può essere utilizzato esclusivamente da professionisti in possesso di un adeguato livello di capacità ed esperienza.

As a fast curing anchoring adhesive for all grades of:

- Rebars / reinforcing steel
- Threaded rods
- Bolts and special fastening systems

In the following substrates:

- Concrete
- Hollow and solid masonry
- Hard natural stone*
- Solid rock*

* These substrates may vary greatly, in particular with regard to strength, composition and porosity. Therefore, for each application the suitability of Sika Sika AnchorFix[®] S adhesive must be tested by first applying the Product only to a sample area. Check in particular bond strength, surface staining and discolouration.

CARATTERISTICHE / VANTAGGI

- Fast curing
- Non-sag, even overhead
- ETA for anchoring in uncracked concrete
- Low wastage

CERTIFICAZIONI / NORMATIVE

- CE marking and Declaration of Performance as Bonded injection type anchor for use in uncracked concrete according to EAD 330499-00-0601, based on ETA-13/0721 of 18/05/2018 and certificate of constancy of performance of the construction product issued by notified product certification body.

INFORMAZIONI DI PRODOTTO

Imballaggio	300 ml standard cartridge	12 cartridges per box
	380 ml standard cartridge	pallet: 75 boxes
		12 cartridges per box
		pallet: 60 boxes
Colore	Component A:	white
	Component B:	black
	Component A+B mixed:	light grey
Durata di conservazione	12 months from date of production All Sika AnchorFix® S cartridges have the expiry date printed on the label.	
Condizioni di immagazzinamento	Stored properly in original, unopened, sealed and undamaged packaging in dry conditions at temperatures between +5 °C and +25 °C. Protect from direct sunlight.	
Densità	~1.7 kg/l (component A+B mixed)	

INFORMAZIONI TECNICHE

Resistenza a compressione	~74 N/mm ² (7 days, +20 °C)	(ASTM D 695)
Modulo di elasticità a compressione	~3 100 N/mm ² (7 days, +20 °C)	(ASTM D 695)
Resistenza a flessione	~24 N/mm ² (7 days, +20 °C)	(ASTM D 790)
Resistenza a trazione	~12 N/mm ² (7 days, +20 °C)	(ASTM D 638)
Resistenza termica		
Temperatura di servizio	Long term	-40 °C min. / +50 °C max. (ETAG 001, Part 5)
	Short term (1–2 hours)	+80 °C

INFORMAZIONI PER L'APPLICAZIONE

Rapporto di miscelazione	Component A : component B = 10 : 1 by volume		
Spessore strato	3 mm max.		
Tixotropia	Non-sag, even overhead		
Temperatura del prodotto	Sika AnchorFix® S must be at a temperature of between +5 °C and +40 °C for application.		
Temperatura ambiente	+5 °C min. / +40 °C max.		
Punto di rugiada	Beware of condensation. Substrate temperature during application must be at least 3 °C above dew point.		
Temperatura del substrato / supporto	+5 °C min. / +40 °C max.		
Tempo di indurimento	Temperature	Open time - T_{gel}	Curing time - T_{cur}
	+40 °C	1.5 minutes	10 minutes
	+35 °C – +40 °C	1.5 minutes	15 minutes
	+30 °C – +35 °C	2 minutes	20 minutes
	+25 °C – +30 °C	3 minutes	30 minutes
	+20 °C – +25 °C	4 minutes	40 minutes
	+10 °C – +20 °C	6 minutes	80 minutes
	+5 °C – +10 °C	12 minutes	120 minutes
	+5 °C*	18 minutes	120 minutes

*Minimum cartridge temperature: +5 °C

ISTRUZIONI PER L'APPLICAZIONE

QUALITA' DEL SUPPORTO / SUBSTRATO

- Mortar and concrete must be at the required strength. No need to be 28 days old.
- Substrate strength (concrete, masonry, natural stone) must be verified.
- Pull-out tests must be carried out if the substrate strength is unknown.
- The anchor hole must always be clean, dry, free from oil and grease etc.
- Loose particles must be removed from the holes.
- Threaded rods and rebars have to be cleaned thoroughly from any oil, grease or any other substances and particles such as dirt etc.

MISCELAZIONE

Getting the cartridge ready: 300 ml

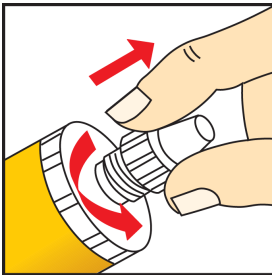

1. Unscrew the cap

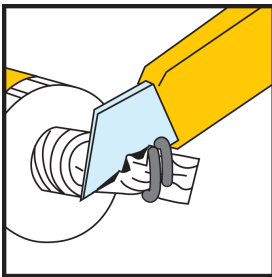

2. Cut the film

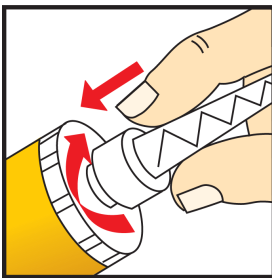

3. Screw on the static mixer

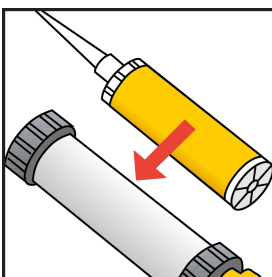

4. Place the cartridge into the gun and start application

Getting the cartridge ready: 380 ml

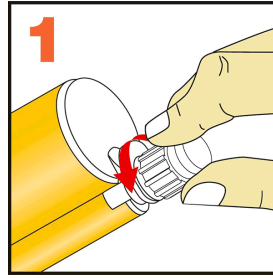

1. Unscrew the cap

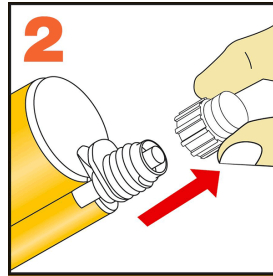

2. Screw on the static mixer

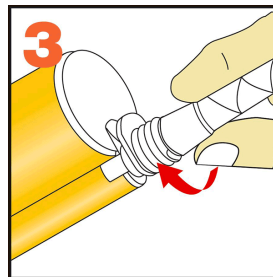

3. Place the cartridge into the gun and start application

When the work is interrupted the static mixer can remain on the cartridge after the gun pressure has been relieved. If the resin has hardened in the nozzle when work is resumed, a new nozzle must be attached.

METODO / ATTREZZATURA DI APPLICAZIONE

Anchors in solid masonry/concrete

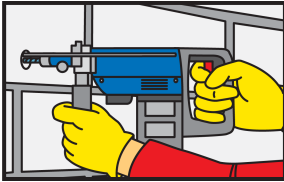

Drilling of hole with an electric drill to the diameter and depth required. Drill hole diameter must be in accordance with anchor size.

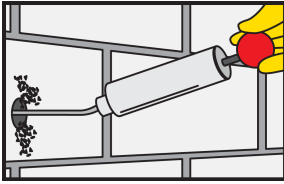

The drill hole must be cleaned with a blow pump or by compressed air, starting from the bottom of the hole. (at least 2x)

Important: use oil-free compressors.



The drill hole must be thoroughly cleaned with the special steel brush (brush at least 2x). The diameter of the brush must be larger than the diameter of the drill hole.

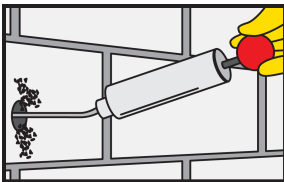

The drill hole must be cleaned with a blow pump or by compressed air, starting from the bottom of the hole (at least 2x).

Important: use oil-free compressors.

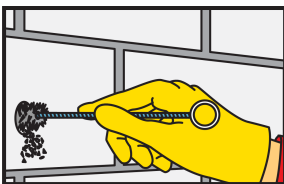

The drill hole must be thoroughly cleaned with the special steel brush (brush at least 2x). The diameter of the brush must be larger than the diameter of the drill hole.

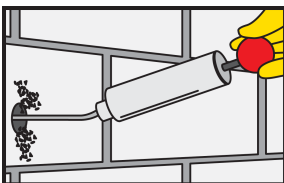

The drill hole must be cleaned with a blow pump or by compressed air, starting from the bottom of the hole (at least 2x).

Important: use oil-free compressors.

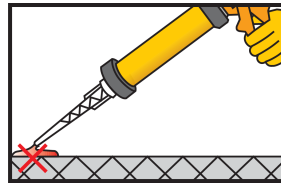

Pump approx. twice until both parts come out uniformly. Do not use this material. Release the gun pressure and clean the cartridge opening with a cloth.

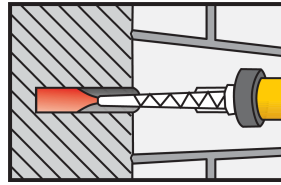

Inject the adhesive into the hole, starting from the bottom, while slowly drawing back the static mixer. In any case avoid entrapping air. For deep holes extension tubing can be used.

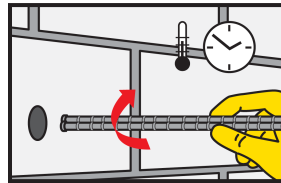

Insert the anchor with a rotary motion into the filled drill hole. Some adhesive must come out of the hole.

Important: the anchor must be placed within the open time.

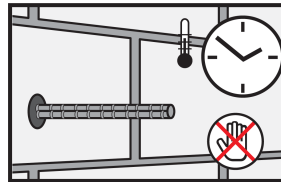

During the resin hardening time the anchor must not be moved or loaded. Wash tools immediately with Sika® Colma Cleaner.

Wash hands and skin thoroughly with warm soap water.

Anchors in hollow blocks

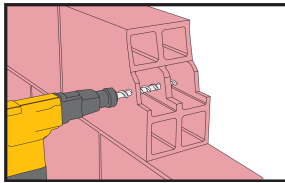

Drilling of hole with an electric drill to the diameter and depth required. Drill hole diameter must be in accordance with anchor-and perforated sleeve size.

Note: with hollow material do not use rotary hammer drills.

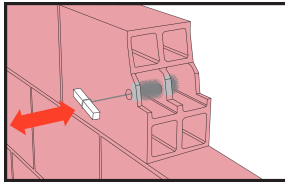

The drill hole must be thoroughly cleaned with a round brush (brush at least 1x). The diameter of the brush must be larger than the diameter of the drill hole.

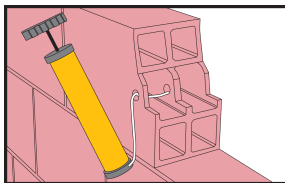

The drill hole must be cleaned after each cleaning step with a blow pump or by compressed air, starting from the bottom of the hole (pump at least 1x).

Important: use oil-free compressors.

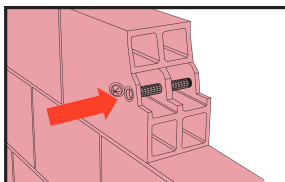

Insert perforated sleeve completely into the drill hole.

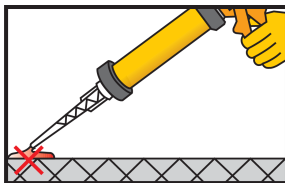

Pump approx. twice until both parts come out uniformly. Do not use this material. Release the gun pressure and clean the cartridge opening with a cloth.

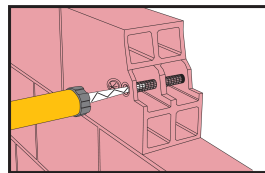

Inject the adhesive into the perforated sleeve, starting from the bottom, while slowly drawing back the static mixer. In any case avoid entrapping air.

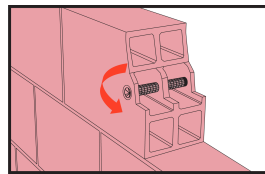

Close the cap from the perforated sleeve to avoid some escape of the resin during entering the steel rod.

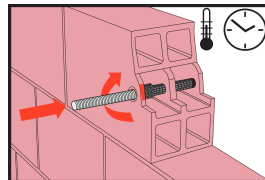

Insert the anchor with a rotary motion into the filled perforated sleeve. Use the adequate steel rod size.

Important: the anchor must be placed within the open time.

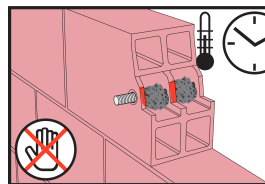

During the resin hardening time the anchor must not be moved or loaded. Wash tools immediately with Sika® Colma Cleaner.

Wash hands and skin thoroughly with warm soap water.

ULTERIORI DOCUMENTI

For specific information on design refer to the separate documentation provided:

Technical Documentation Sika AnchorFix® S 870 43 03

VALORI BASE

Tutti i dati tecnici riportati in questa Scheda Dati Prodotto sono basati su test di laboratorio. I dati di misurazione effettiva possono variare a causa di circostanze al di fuori del nostro controllo.

RESTRIZIONI LOCALI

A seconda delle normative specifiche locali le prestazioni di questo prodotto possono variare da Paese a Paese. Si prega di consultare la Scheda Dati Prodotto locale per la descrizione esatta dei campi di applicazione.

ECOLOGIA, SALUTE E SICUREZZA

Per informazioni e consigli sulla manipolazione sicura, lo stoccaggio e lo smaltimento di prodotti chimici, l'utente deve far riferimento alla più recente Scheda di Sicurezza, contenente i dati fisici, ecologici, tossicologici ed altri dati relativi in tema di sicurezza.

NOTE LEGALI

Le informazioni e, in particolare, le istruzioni relative all'applicazione e all'uso finale dei prodotti Sika sono fornite in buona fede in base alle conoscenze ed all'esperienza attuale di Sika sui prodotti a condizione che gli stessi vengano adeguatamente immagazzinati, movimentati ed utilizzati in condizioni normali ed osservando le raccomandazioni di Sika. Nella pratica, le differenze di materiale, substrati e reali condizioni del luogo sono così varie che non può essere rilasciata alcuna garanzia per la commerciabilità o l'idoneità per uno scopo particolare, allo stesso modo nessuna responsabilità derivante da qualsiasi rapporto giuridico può essere dedotta da queste informazioni, da qualsiasi raccomandazione scritta o da ogni altra consulenza prestata. L'utente deve testare l'idoneità del prodotto per l'applicazione prevista e la relativa finalità. Sika si riserva il diritto di modificare le proprietà dei suoi prodotti. Devono essere rispettati i diritti di proprietà di terzi. Tutti gli ordini vengono accettati alle nostre vigenti condizioni di vendita e consegna. Gli utilizzatori devono fare sempre riferimento alla versione più recente della locale scheda tecnica relativa al prodotto in questione, le cui copie verranno fornite su richiesta.

Sika Italia S.p.A.

Via Luigi Einaudi, 6
20068 Peschiera Borromeo (MI)
Phone: +39 02 54778 111
Fax: +39 02 54778 119
info@sika.it
www.sika.it



SISTEMA DI GESTIONE
QUALITÀ
UNI EN ISO 9001:2008
CERTIFICATO DA
CERTIQUALITY
N. 951

Scheda Dati Prodotto
Sika AnchorFix® S
Maggio 2019, Version 02.08
020205010010000003

SikaAnchorFixS-it-IT-(05-2019)-2-8.pdf